

Annex I Haxby & Wigginton Ward

11

Location: Kirkcroft and Minster Close

Nature of problem and advertised proposal

Cllr. Pearson and a resident requested restrictions at the junction of Kirkcroft/Minster Close due to vehicles parking close to the junction and restricting visibility.

Plan of proposed restrictions:

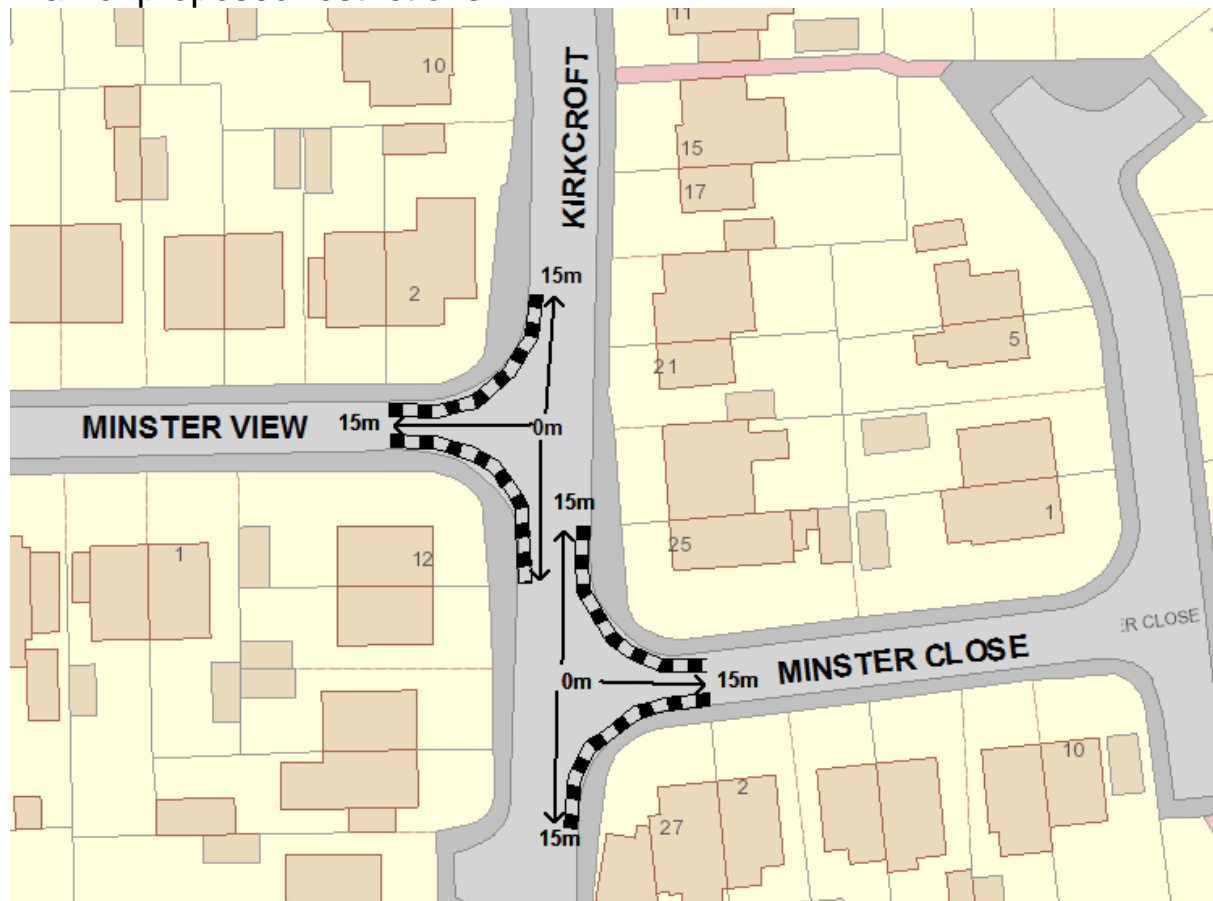

Representations received

We received one representation in objection and one in support of the proposed restrictions.

Representation in objection:

- 1. My home is in the middle of a zone and I did not or want to live in a parking restricted zone.
- 2. There has been no formal consultation process for residents these changes would impact.
- 3. The introduction of these restrictions will devalue my property.
- 4. If these restrictions are introduced people will just park elsewhere, not removing the problem just move the problem, a problem that does not exist.
- 5. This is another waste of council resources on something that is

not needed.

6. Building work at a close property passed by the council through planning (since March) has seen a number of work vehicles but this work is now complete.

7. With the demo graphic in the area there is a need for carers/doctors/home helps and food delivery and this will restrict these essential services.

8. By introducing these measures you are encouraging speed of vehicles with no reasons to take care as there will be no vehicles.

9. We are a small community and in 47 years of been a resident in this community these restriction have not been and are not needed.

10. Our household currently has two NHS workers and a social caters and these restrictions would make it hard to park for these essential service workers.

11. These restrictions would introduce neighbourhood conflict as a result of residents having to park outside others homes.

12. This is an attempt to introduce a commercial viable restrictions where the City Council would gain financially when the restrictions are not followed when the council they are meant to provide services.

13. There is no known reason why these restriction would be introduced.

14. Signage and marking would have to be put in place and maintained costing money that should be spent on more essential needs of the village.

15. The cost of managing these restriction is a misuse of council funds.

16. With living in the middle of a proposed restricted area I would have to look at removing my grasses front garden and installing vehicle hard standing having an impact on the environment.

17. No known accidents in the area.

18. No issues with driveways been kept clear with neighbours having understanding.

19. The is reference "Annual Review" yet it's the first time we have seen this kind of document so it can't be an annual review.

20. Residents would just park on the road leaving driveways clear so they keep their space outside their home for their use.

Representation in support:

- There are frequently cars parked on both sides of the road here leaving a very small space to actually drive down Kirkcroft. This obstruction also means that it is hard to see if there is any traffic

approaching from the other side of the parked cars making it risky when driving through the gap.

Also when I drive out of Minster Close my view of the oncoming traffic on Kirkcroft is more often than not blocked by parked cars on both sides. I feel it is only a matter of time before an accident occurs here if it has not already.

Officer analysis and recommendation

Vehicles parking close to the junctions is restricting visibility for drivers exiting those junctions. Placing restrictions in an area will lead to a displacement of parking but will also remove vehicles parking close to the junctions. restrictions on the junctions should not encourage vehicles to drive at an increased speed as entering/ exiting a junction should always be completed with caution.

Options.

- 1. Implement as Advertised-** recommended for the reasons outlined above
- 2. Take no further action-** Not recommended.
- 3. Implement a lesser restriction than advertised-** Not recommended

12

Location: The Village, Haxby

Nature of problem and advertised proposal

A resident has raised an issue of parked vehicles being collided in to due to vehicles not waiting for oncoming vehicles to pass. The resident requested an extension to the existing no waiting at any time restriction on The Village.

Images provided of damage and debris following two collisions:



Plan of proposed restrictions:

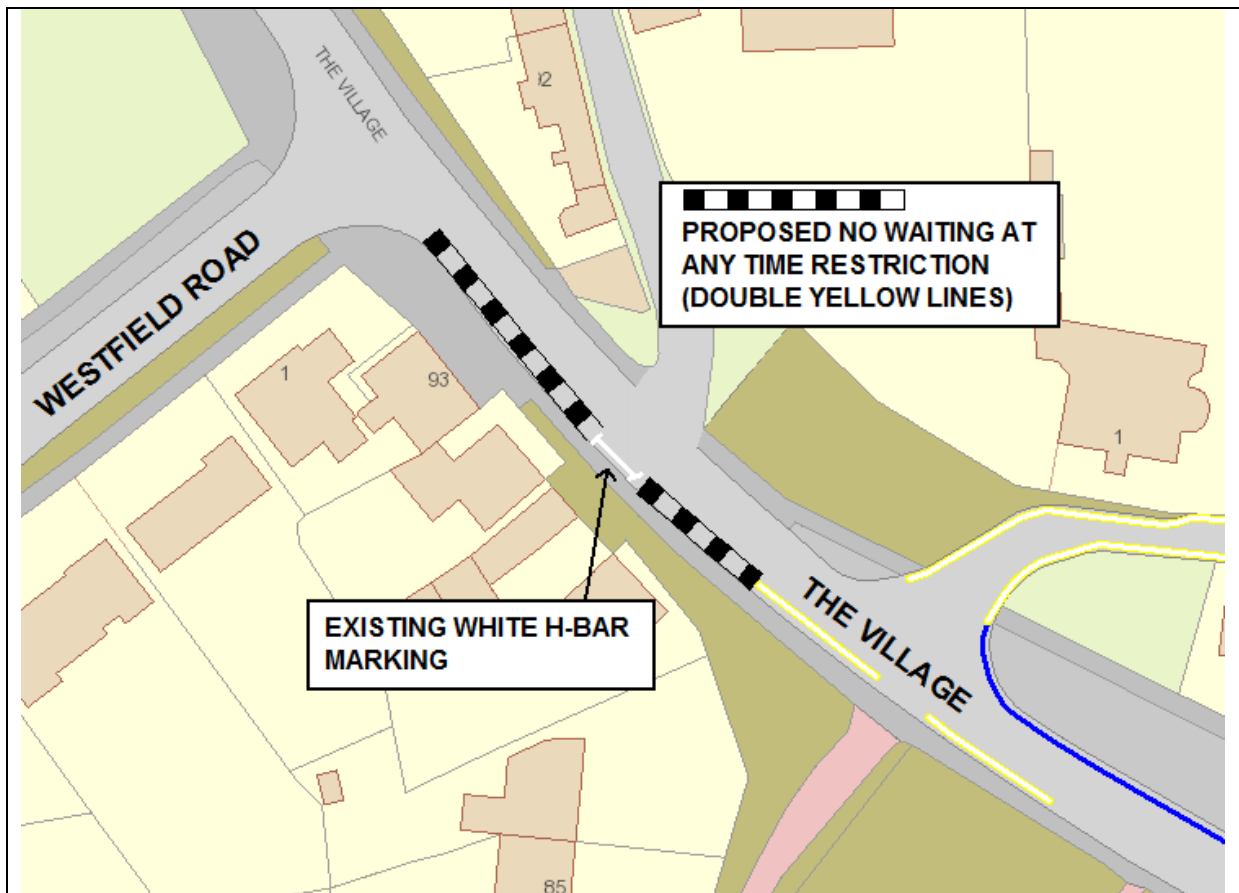

Representations received

We received three representations in objection and one in support of the proposed restrictions.

Representations received:

- I would like to object to the double yellow line outside my office/warehouse on The village Haxby York YO32 2JE as this will only lead to parking on the opposite side of the road and more parking problems down Westfield Road. Which will make it more difficult for the buses which turn left into Westfield Road and when coming out of Westfield Road they turn right if car's are parked opposite my company which they will do if you yellow line as proposed.
- 1. We strongly object to the proposal to introduce a "No waiting at anytime restriction" outside our property. This will only encourage parking on the other side of the road, considerably affecting the junction with Westfield Road.
2. As residents of The Village we never have vehicles parking alongside the dropper kerb to access our property nor the dropper kerb which continues across the forecourt of Northern Scientific - the business at no. 93.
3. On occasion we have two vehicles parked in front of our property from the H bar at no.89. We have no problem with this

and are not aware of any incident issues that have prompted this proposal.

4. Therefore it would be helpful to us that the proposal does NOT go ahead. However should the proposal proceed it would be appreciated that the restriction is shortened to finish at our dropper kerb and not across our access. Alternatively as a neighbouring property has an H bar to protect their access, an H bar across our access would be acceptable.

5. We are well aware of the weekday parking in this area and really do not feel it is necessary to have this additional restriction within the village. We trust that every consideration is given to our objection and a sensible satisfactory conclusion is reached.

- I live on The Village Haxby and strongly object to the above proposal.

I have no driveway and as such rely on on street parking.

The open parking in front of my property is invariably full.

There is no time limit for parking in front of my house and as such I know that people park for long periods including the whole day for work purposes, for many hours in the day / evening to socialise in the village or attend appointments and to go shopping in the village.

There are numerous occasions where I cannot park here and sometimes my only option is to park at the side of the picket fence adjacent to the village green - which I believe is what this proposed change relates to.

If this becomes a no waiting area my options for parking close to my property will be severely restricted.

If this is to be the case then I strongly feel that the area in front of my property should have a restricted time limit - maximum 60mins and residents permits should be offered for those that require them.

There are two cottages in my row which I believe have no provision for parking at the back.

The majority of the cottages opposite me do not have their own parking.

As such many of The Village households are trying to get a spot at various times of the day / night.

I am a woman on my own and I do not want to have to park my car huge distances from my property for:

Safety reasons - particularly in the dark.

Bringing in shopping and other goods.

Safely transferring my granddaughter to my property.

I don't want to impact other streets.

This proposal will restrict my parking availability by 4 spaces and I feel the proposal will mean I have to park quite a distance from my property potentially impacting on other residents.

I have no option but to have a car - I work as a nurse and need it to travel long distances to visit patients at home.

Representation in support:

- We would like, wholeheartedly, to support the proposed amendment to the traffic regulation, continuing the existing short stretch of double yellow lines from Westfield Road, Haxby along to the green.

The proposal would alleviate the increasing congestion around this bend on the main road in Haxby. This is a section of the main road which experiences heavy traffic flow for most of the day. There are regular buses travelling in both directions, unable to pass and creating frequent queueing. Access and egress of emergency vehicles to and from the medical centre is detrimentally affected by cars parked on both sides of the road at both ends of two consecutive significant bends in the main road. The relocation of the pharmacy to the opposite side of the road to the medical centre has further exacerbated the congestion, with a constant flow of short stay parking outside.

In addition, the sightline from the driveway of our house (house number redacted) is now so severely compromised that we have narrowly escaped collisions of several occasions just trying to turn left or right out of our property onto the road. Up to three cars parked adjacent to and each side of the access to our drive are regularly obscuring the view in both directions. If just one of these vehicles either side is larger than a regular car (and this happens daily) the view in that direction is completely blocked and we have to pull out into moving traffic and hope that the oncoming vehicle recognises our plight and allows us a safe passage through to the road. Additionally, cars have taken to pulling in to the gap immediately outside our drive, between the parked cars either side, to allow oncoming traffic through. At weekends this can mean we are precluded from leaving the house for extended periods whilst traffic queues in both directions.

We would welcome a site visit from a Highways representative in order to demonstrate how much difference it would make to the safety of drivers and pedestrians to add a short extension to the existing double yellow lines.

Officer analysis and recommendation

The accident data team have confirmed there has been no reported accidents that involve any injuries at this location. However, we do have

images of collisions that have caused damage to parked vehicles. Two objectors have advised they have dropped kerbs and do not support restrictions in front of their dropped kerbs.

Options.

1. **Implement as Advertised- Not recommended**
2. **Take no further action- Not recommended**
3. **Implement a lesser restriction than advertised- Recommended. The location of the dropped kerbs will effectively provide the same restriction of parking without the need for double yellow lines in front of them.**

